

TORQUE AND ANGLE TRANSDUCERIZED CONTROL TOOLS

EB series / B series / ALPHA V QBE controllers



STANLEY[®]



PRODUCTIVE SOLUTIONS

As an industrial process expert, we help you meet your challenges.

Productivity, safety, quality, industry 4.0 are themes on which we can offer you our expertise and our solutions. Whether in the field of assembly technology, machining or welding, our dedicated and specialized teams accompany your progress and recommend solutions and equipment to reach performance levels in line with your industrial strategy.



Certified quality

From design to commissioning, DOGA guarantees the quality of this equipment and services according to ISO 9001: 2015 certification.

5 reasons to trust us



Expertise

Our Field experts propose solutions adapted to your environment and specific needs.



Innovation

By developing the products and the services of tomorrow, we offer you new perspectives or prospects.



Performance

Our high added value solutions improve your performance and guarantee the final quality of the production.



Commitment

Aware of your objectives, we commit ourselves to helping you to reach them.



Reliability

Our organization, which has been ISO 9001 certified since 1996, is the guarantee of your satisfaction.



ASSEMBLY TECHNOLOGY

As a world class assembly technology player, we manufacture and market equipment and solutions for the assembly industry which contribute to the improvement of your manufacturing quality and productivity.

Our assembly, ergonomics and traceability solutions contribute to enhancing your productivity, controlling your process quality and meeting the requirements of industry 4.0.

We offer products designed to last and high value-added services by relying on our team's know-how and expertise: design, production, installation, start-up, training and maintenance.

We support you locally thanks to our worldwide presence through our subsidiaries and our specialized distribution network.



Contact us

@ international@dogas.com

+33 1 30 66 41 41

www.dogasassembly.com

SUMMARY

TORQUE AND ANGLE TRANSDUCERIZED CONTROL TOOLS

EB series / B series / ALPHA V QBE controllers

▶	DON'T ESTIMATE YOUR TORQUE...MEASURE IT !	4
▶	TORQUE AND ANGLE TRANSDUCERIZED CONTROL SCREWDRIVERS - EB SERIES	5
	Straight electric screwdrivers - EB series	7
	Angle head electric screwdrivers - EB series	8
	Pistol electric screwdrivers - EB series	9
▶	TORQUE AND ANGLE TRANSDUCERIZED CONTROL SPINDLES - EB SERIES	11
	Retractable axial spindles - EB series	12
▶	TORQUE AND ANGLE TRANSDUCERIZED CONTROL CORDLESS SCREWDRIVERS - B SERIES	13
	Straight cordless screwdrivers - B series	15
	Pistol cordless screwdrivers - B series	16
	Angle head cordless screwdrivers - B series	17
	Batteries for screwdrivers - B series	18
▶	ALPHA V QBE CONTROLLERS	19
	Alpha V QBE Advanced controller	21
	Alpha V QBE Expert controller	22
	Alpha V QBE Node controller	23
	Alpha V QBE Specialist controller	24
	Alpha V QBE Node Network controller	25
	ALPHA ToolBox software	26
	ATC adaptive tightening control function	27
	ATC+ auto-adaptive tightening control function	27
▶	ACCESSORIES	28
▶	EXAMPLES OF INTEGRATION	31
▶	OUR SERVICES	31

DO NOT ESTIMATE YOUR TORQUE... MEASURE IT !

Faced with ever more stringent requirements in terms of productivity, quality, safety, ergonomics and the environment, more and more industries are turning to torque and angle transducerized control electric screwdriving.

If this is your approach, our torque and angle transducerized control solutions will meet your needs.

The torque sensor... A guarantee of quality!

Our tools incorporate a sensor to measure torque dynamically and report the result actually applied at the end of tightening (when rotation comes to a complete stop).

Combined with an angular encoder, our tools are the perfect answer to all your needs for combined « torque / angle » verification.

This makes it possible to implement tightening strategies that validate quality control at the end of the tightening process (presence of seals, washers, intermediate parts, etc.).

Once configured, our tools adapt to variations in the mechanical characteristics of the assembly thus avoiding the application of a sometimes very large and unmeasured 'over-torque'.

Within the same batch of parts, their characteristics may vary, just as, on the same part, the different assembly points not have the same hardness or elasticity.

A torque sensor is therefore fully justified to overcome these differences.



With their new high-performance electric motor combined with a new reducer, STANLEY® tools offer the best power-to-weight ratio on the market. The range of associated controllers allows an optimised solution to be implemented through the application of advanced tightening strategies, including for multi-spindle applications with synchronisation.



RELIABILITY

STANLEY® torque and angle screwdrivers are designed for your most critical tightening operations requiring accuracy, tightening repeatability, mechanical reliability and data traceability. They guarantee you high-quality manufacturing and the desired productivity.



ERGONOMICS

Whatever your application, there's a STANLEY® screwdriver to suit! Corded or cordless, each screwdriver comes with a range of options and accessories to optimise the ergonomics of your screwdriving workstation.



Straights: equipped with a lever or push to start system, they are intended for portable use or to be supported by a torque reaction arm. They can also be used in automated solutions thanks to the various optional mounting brackets.



Pistols: the operator activates the start with a trigger or a push start system. They are intended for portable use or to be supported by a torque reaction arm beyond 10 Nm.

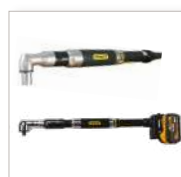

Angle head: fitted with an ergonomic lever for starting, they can be equipped with a transmission axis to allow access to screwing points in a reduced environment.



Spindles: They are designed for your automated tightening operations requiring tightening repeatability, mechanical reliability and data traceability.

TORQUE AND ANGLE TRANSDUCERIZED CONTROL SCREWDRIVERS - EB SERIES



EB series transducerized tools with torque sensor is suitable with the Alpha V QBE range of controllers (see page 19) Their accuracy makes them ideal for the most demanding applications.



Straight and pistol screwdrivers:

tolerance of +/- 5 % with capability

Angle head screwdrivers:

tolerance of +/- 10 % with capability

Technical specifications

- ▶ Torque sensor with signal digitization in the tool.
- ▶ Sinusoidal resolver for angle encoding with an accuracy of 0.1°.
- ▶ Reprogrammable tool card (integration of a torque multiplier, a transmission axis, etc.).
- ▶ Electronic chip allowing automatic identification of the tool by the controller and containing information such as: type, serial number, calibration value, number of cycles performed.
- ▶ Optional redundant sensor (on spindles only).

OVERVIEW

New brushless electric motor

- High performance
- Low consumption
- Robust motor protection

Composite handle with a grip

- Weight reduction
- Operator comfort

New high-speed reducer

- Friction reduction
- Silent operation
- Increased reliability



LED indicators visible at 360

- Better view of tightening results



Built-in multi-function button

- Select between 2 programmed jobs
- Transparent protection for multi-function panel and model label



Ergonomic start lever

- Optical switch
- Long life

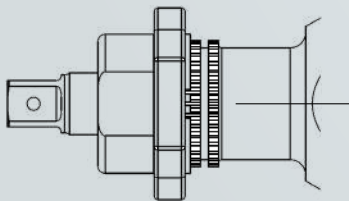

Optional outputs

- Hexagonal 1/4
- Square 3/8

Status indicators

Push to start

- Option
- Silent
- Increased reliability



- Composite handle**
- Ergonomic design
 - Operator comfort

Programmable buttons

- Greater efficiency



Lighting of the screwing point

Straight electric screwdrivers - EB series



✓ Productivity

- Excellent weight / power / speed ratio

✓ Ergonomics

- Lightweight and compact
- Optional long lever available (see page 29)

✓ Quality

- Digital torque sensor and angle encoder with 0.1° accuracy

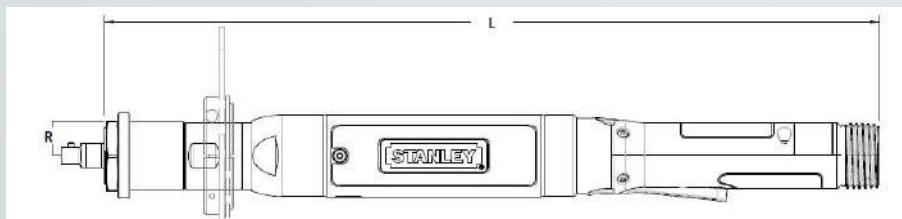

Straight electric screwdrivers lever start

Designation	Torque maxi (Nm)	Speed (rpm)	R (mm)	L (mm)	Weight (kg)	Drive* (standard)	Code
EB12LB-2	2	1760	17,8	359	0,69	Hex 1/4" F	P103136
EB12LB-4	4	1115	17,8	359	0,69	Hex 1/4" F	P104313
EB12LB-6	6	2300	17,8	359	0,69	Hex 1/4" F	P105625
EB12LB-9	9	1595	17,8	359	0,69	Hex 1/4" F	P103132
EB12LB-14	14	1020	17,8	359	0,69	Hex 1/4" F	P101995
EB22LB-16	16	1340	23,7	352	1,06	Carré 3/8"	P104884
EB22LB-20	20	1071	23,7	365	1,10	Carré 3/8"	P106779
EB33LB-28	28	1590	24,7	416	1,40	Carré 3/8"	P102887
EB33LB-40	40	1120	24,7	416	1,40	Carré 3/8"	P103813
EB34LB1-55	55	830	26,7	463	2,04	Carré 1/2"	P112594
EB44LB1-80	80	895	26,7	479	2,50	Carré 1/2"	P113096
EB55LB1-100	100	853	32	479	5,17	Carré 1/2"	P112598
EB44LB1-120	120	560	26,7	479	2,85	Carré 1/2"	P104309
EB55LB2-120	120	850	32	564	5,17	Carré 3/4"	P170315
EB45LB2-140	140	465	29	533	3,42	Carré 3/4"	P170314
EB55LB2-170	170	640	32	560	4,62	Carré 3/4"	P108799
EB45LB2-190	190	355	29	533	4,30	Carré 3/4"	P170310
EB55LB2-250	250	400	32	560	4,93	Carré 3/4"	P116839
EB55LB3-320	320	310	32	573	5,01	Carré 3/4"	P170317
EB55LB4-460	460	220	44	621	7,60	Carré 1"	P106767
EB55LB4-620	620	165	44	621	7,60	Carré 1"	P112506
EB55LB5-800	800	125	48	651	10,05	Carré 1"	P170327
EB55LB5-1100	1100	80	48	651	10,05	Carré 1"	P170325
EB55LB5-1500	1500	60	48	683	10,05	Carré 1"	P113130
EB55LB5-2000	2000	50	48	683	10,57	Carré 1"	P170326

Straight electric screwdrivers push start

Designation	Torque maxi (Nm)	Speed (rpm)	R (mm)	L (mm)	Weight (kg)	Drive* (standard)	Code
EB12LP-2	2	1760	20,4	359	0,85	Hex 1/4"	P170312
EB12LP-4	4	1115	20,4	359	0,85	Hex 1/4"	P108918
EB12LP-6	6	2300	20,4	359	0,85	Hex 1/4"	P106951
EB12LP-9	9	1595	20,4	359	0,85	Hex 1/4"	P106759
EB12LP-14	14	1020	20,4	359	0,85	Hex 1/4"	P113060

* Other drives on request.

Angle head electric screwdrivers - EB series



✓ Productivity

- Excellent weight / power / speed ratio

✓ Ergonomics

- Lightweight and compact
- Tools available in integrated socket, old and drive, transmission axis versions, etc.

✓ Quality

- Digital torque sensor and angle encoder with 0.1° accuracy

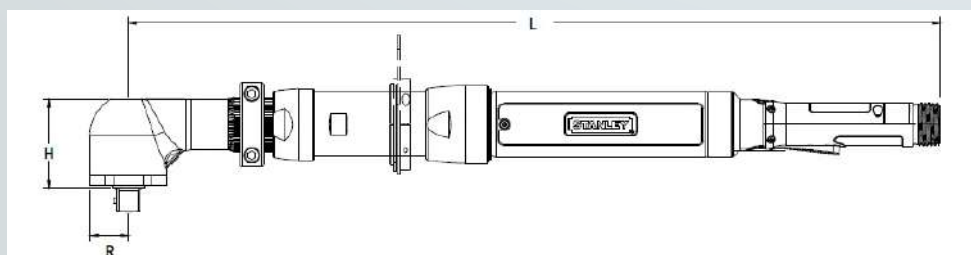

Angle head electric screwdrivers lever start

Designation	Torque maxi (Nm)	Speed (rpm)	R (mm)	L (mm)	H (mm)	Weight (kg)	Drive* (standard)	Code
EB12LA10-6	6	2110	10	319,3	31,9	0,89	Carré 1/4"	P112572
EB12LA13-8	8	1400	13	321,6	32,7	0,93	Carré 3/8"	P170212
EB12LA13-13	13	970	13	321,6	32,7	0,93	Carré 3/8"	P103479
EB22LA13-13	13	1550	13	343,3	32,7	1,08	Carré 3/8"	P102136
EB22LA13-18	18	1075	13	343,3	32,7	1,08	Carré 3/8"	P101224
EB22LA15-24	24	825	15	366,5	36,5	1,21	Carré 3/8"	P106754
EB33LA15-27	27	1515	15	415,7	36,5	1,55	Carré 3/8"	P103838
EB33LA18-35	35	1165	18	444,7	39,3	1,66	Carré 3/8"	P102461
EB33LA15-40	40	1015	15	415,7	36,5	1,55	Carré 3/8"	P108892
EB33LA19-40	40	1025	19	458,4	48,7	1,87	Carré 1/2"	P170213
EB33LA18-48	48	880	18	455,4	39,3	1,66	Carré 3/8"	P106846
EB44LA19-55	55	1190	19	458,4	48,7	2,78	Carré 1/2"	P170215
EB33LA19-60	60	680	19	458,4	48,7	2,04	Carré 1/2"	P104301
EB34LA19-70	70	610	19	488,0	48,7	2,34	Carré 1/2"	P112584
EB34LA22A-80	80	510	22	530,0	50,0	2,66	Carré 1/2"	P170214
EB44LA22A-80	80	810	22	539,0	50,0	3,10	Carré 1/2"	P170216
EB34LA22A-115	115	340	22	530,0	50,0	2,66	Carré 1/2"	P112508
EB44LA22A-120	120	550	22	539,0	50,0	3,29	Carré 1/2"	P105692
EB55LA26-120	120	825	26	632,0	60,0	5,72	Carré 3/4"	P170218
EB55LA26-160	160	620	26	632,0	60,0	5,81	Carré 3/4"	P113054
EB45LA26-165	165	400	26	582,0	60,0	5,25	Carré 3/4"	P106801
EB45LA26-220	220	260	26	582,0	60,0	5,57	Carré 3/4"	P105708
EB55LA26-220	220	460	26	632,0	60,0	5,83	Carré 3/4"	P104260
EB55LA32-300	300	340	32	639,0	73,0	6,46	Carré 3/4"	P108703
EB55LA32-400	400	225	32	639,0	73,0	6,46	Carré 3/4"	P108629

* Other drives on request.

Pistol electric screwdrivers - EB series



✓ Productivity

- Excellent weight / power / speed ratio

✓ Ergonomics

- Lightweight and compact
- TOP EXIT version: with output of the cable on the top
- Trigger or push start
- Soft and ergonomic handle
- Rotating reaction bar

✓ Quality

- Digital torque sensor and angle encoder with 0.1° accuracy



TOP EXIT
version



Rotating
reaction bar

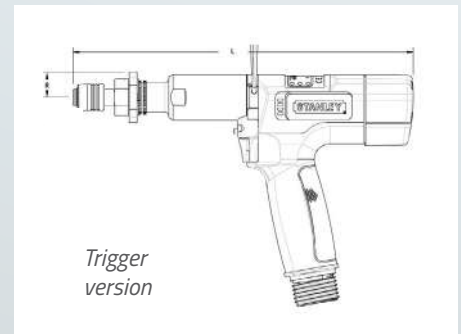

Trigger
version

Pistol electric screwdrivers trigger start

Designation	Torque maxi (Nm)	Speed (rpm)	R (mm)	L (mm)	Weight (kg)	Drive (standard)	Code
EB12PB-2	2	1760	20	222	0,78	Hex 1/4"	P170204
EB12PB-2 TOP EXIT	2	1760	20	222	0,78	Hex 1/4"	P170262
EB12PB-4	4	1115	20	222	0,78	Hex 1/4"	P112706
EB12PB-4 TOP EXIT	4	1115	20	222	0,78	Hex 1/4"	P170263
EB12PB-6	6	2300	20	264	0,78	Hex 1/4"	P112984
EB12PB-6 TOP EXIT	6	2300	20	264	0,78	Hex 1/4"	P108731
EB12PB-9	9	1595	20	264	0,78	Hex 1/4"	P104297
EB12PB-9 TOP EXIT	9	1595	20	264	0,78	Hex 1/4"	P105746
EB12PB-14	14	1020	20	264	0,78	Hex 1/4"	P102454
EB12PB-14 TOP EXIT	14	1020	20	264	0,78	Hex 1/4"	P170264
EB22PB-16	16	1225	20	290	1,16	Hex 1/4"	P113024
EB22PB-20	20	981	20	290	1,21	Hex 1/4"	P170256
EB33PB-28	28	1590	26	288	1,49	Carré 3/8"	P108828
EB33PB-28 TOP EXIT	28	1590	26	288	1,49	Carré 3/8"	P112521
EB33PB-40	40	1120	26	288	1,55	Carré 3/8"	P112992
EB33PB-40 TOP EXIT	40	1120	26	288	1,55	Carré 3/8"	P112525
EB34PB1-55	55	830	32	324	2,31	Carré 1/2"	P170211
EB34PB1-55 TOP EXIT	55	830	32	324	2,31	Carré 1/2"	P170270
EB34PB1-75	75	545	32	324	2,55	Carré 1/2"	P108830
EB34PB1-75 TOP EXIT	75	545	32	324	2,55	Carré 1/2"	P170271
EB34PB1-105	105	410	32	324	2,55	Carré 1/2"	P170210
EB34PB1-105 TOP EXIT	105	410	32	324	2,55	Carré 1/2"	P108630
EB35PB2-160	160	280	34	380	-	Carré 3/4"	P170201
EB35PB2-160 TOP EXIT	160	280	34	380	-	Carré 3/4"	P170202
EB35PB4-345	345	106	43	440	-	Carré 1"	P170203
EB35PB4-345 TOP EXIT	345	106	43	440	-	Carré 1"	P112976

Pistol electric screwdrivers push start

Designation	Torque maxi (Nm)	Speed (rpm)	R (mm)	L (mm)	Weight (kg)	Drive (standard)	Code
EB12PP-2	2	1760	20	265	0,93	Hex 1/4"	P170206
EB12PP-2 TOP EXIT	2	1760	20	265	0,93	Hex 1/4"	P170266
EB12PP-4	4	1115	20	265	0,93	Hex 1/4"	P170207
EB12PP-4 TOP EXIT	4	1115	20	265	0,93	Hex 1/4"	P170267
EB12PP-6	6	2300	20	265	0,93	Hex 1/4"	P170208
EB12PP-6 TOP EXIT	6	2300	20	265	0,93	Hex 1/4"	P170268
EB12PP-9	9	1595	20	265	0,93	Hex 1/4"	P170209
EB12PP-9 TOP EXIT	9	1595	20	265	0,93	Hex 1/4"	P170269
EB12PP-14	14	1020	20	265	0,93	Hex 1/4"	P170205
EB12PP-14 TOP EXIT	14	1020	20	265	0,93	Hex 1/4"	P170265

Pistol electric screwdrivers trigger start and rotating reaction bar

Designation	Torque maxi (Nm)	Speed (rpm)	R (mm)	L (mm)	Weight (kg)	Drive (standard)	Code
EB35PB2SB-160	160	280	34	422,2	≈ 6,8	Carré 3/4"	P180810
EB35PB4SB-525	525	77	43	489,49	≈ 7	Carré 1"	P180811
EB35PB4SB-680	680	40	43	489,49	7,25	Carré 1"	P180812



TORQUE AND ANGLE TRANSDUCERIZED CONTROL SPINDLES - EB SERIES



The retractable axial spindles are intended to be installed on automated stations. It is started by an external trigger actuated by an operator or directly by the PLC.

- ▶ Multiple spindles can be synchronised using the functions of the range of associated controllers
- ▶ Optional redundant sensor
- ▶ Cable connector rotates 360° in 90° increments
- ▶ Specific outputs available

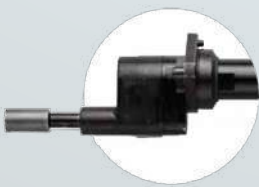

<i>Fixed straight spindle</i>	<i>Retractable straight spindle</i>	<i>Angle head spindle</i>	<i>Retractable angle head spindle</i>
			
<i>Closed geared offset head</i>	<i>Tubenut offset head</i>	<i>Retractable offset spindle</i>	
			 Many options Contact us

Retractable axial spindles - EB series



✓ Productivity

- Multi-spindle synchronisation function

✓ Ergonomics

- Swivel cable connector for confined spaces

✓ Quality

- Tightening repeatability and data traceability
- Mechanical reliability

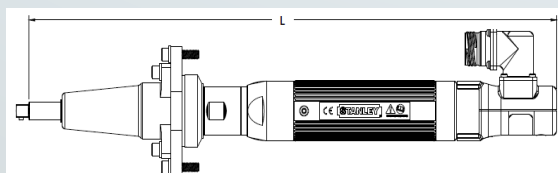

Axial spindles - Telescopic stroke 25 mm

Designation	Torque maxi (Nm)	Speed (rpm)	R (mm)	L (mm)	Weight (kg)	Drive (standard)	Retraction (mm)	Code
EB33MBF1-28	28	1590	28	443	2,56	Carré 3/8"	25	P170242
EB33MBF1-40	40	1120	28	443	2,56	Carré 3/8"	25	P170244
EB34MB1F1-55	55	830	28	499	3,30	Carré 1/2"	25	P105764
EB44MB1F1-80	80	895	28	511	3,80	Carré 1/2"	25	P170245
EB44MB1F1-120	120	560	28	533	3,80	Carré 1/2"	25	P170246
EB45MB2F1-140	140	465	32	600	3,60	Carré 5/8"	25	P170247
EB55MB2F1-170	170	640	32	631	6,50	Carré 5/8"	25	P170229
EB45MB2F1-190	190	355	32	600	3,60	Carré 5/8"	25	P113116
EB55MB2F1-250	250	400	32	654	6,80	Carré 5/8"	25	P170230
EB55MB3F1-320	320	310	34	636	6,70	Carré 3/4"	25	P113086
EB55MB4F1-460	460	220	44	803	17,20	Carré 1"	25	P170248
EB55MB4F1-620	620	165	44	803	17,20	Carré 1"	25	P170232
EB55MB5F1-800	800	125	50	840	18,30	Carré 1"	25	P170249
EB55MB5F1-1100	1100	80	50	863	18,30	Carré 1"	25	P170237
EB55MB5F1-1500	1500	60	50	870	19,20	Carré 1"	25	P170238
EB55MB5F1-2000	2000	50	50	870	19,20	Carré 1"	25	P170239

Axial spindles - Telescopic stroke 51 mm

Designation	Torque maxi (Nm)	Speed (rpm)	R (mm)	L (mm)	Weight (kg)	Drive (standard)	Retraction (mm)	Code
EB33MBF2-28	28	1590	28	534	2,56	Carré 3/8"	51	P105689
EB33MBF2-40	40	1120	28	545	2,56	Carré 3/8"	51	P170250
EB34MB1F2-55	55	830	28	584	3,30	Carré 1/2"	51	P112762
EB44MB1F2-80	80	895	28	611	3,80	Carré 1/2"	51	P170251
EB44MB1F2-120	120	560	28	633	3,80	Carré 1/2"	51	P108713
EB45MB2F2-140	140	465	32	651	3,60	Carré 5/8"	51	P170252
EB55MB2F2-170	170	640	32	681	6,50	Carré 5/8"	51	P170253
EB45MB2F2-190	190	355	32	651	3,60	Carré 5/8"	51	P170254
EB55MB3F2-320	320	310	34	795	6,70	Carré 3/4"	51	P170231
EB55MB4F2-460	460	220	44	908	17,20	Carré 1"	51	P170233
EB55MB4F2-620	620	165	44	908	17,20	Carré 1"	51	P108715
EB55MB5F2-800	800	125	50	945	18,30	Carré 1"	51	P116838
EB55MB5F2-1100	1100	80	50	968	18,30	Carré 1"	51	P170240
EB55MB5F2-1500	1500	60	50	976	19,20	Carré 1"	51	P170241
EB55MB5F2-2000	2000	50	50	976	19,20	Carré 1"	51	P170255

Other optional mounting brackets (see p.29).

TORQUE AND ANGLE TRANSDUCERIZED CONTROL CORDLESS SCREWDRIVERS - B SERIES



The B series cordless tools has the same mechanical design than EB series and can be used with or without controllers thanks to embedded electronics.

This autonomy is particularly appreciated in the case of simple but demanding precision applications.



Axial and pistol screwdrivers: tolerance of +/- 5 % with capability

Angle head screwdrivers: tolerance of +/- 10 % with capability

- ▶ Torque sensor with signal digitization in the tool.
- ▶ Sinusoidal resolver for angle encoding with an accuracy of 0.1 °
- ▶ Reprogrammable tool card (integration of a torque multiplier, a transmission axis, etc.).
- ▶ Electronic chip allowing automatic identification of the tool by the controller and containing information such as: type, serial number, calibration value, number of cycles performed.
- ▶ 5 GHz Wi-Fi wireless communication (IEEE 802 11 a/b/g/n) to QBE Expert, QBE Specialist or QBE Node Network controllers
- ▶ Embedded electronics:
 - Memory for 500 cycles and 2 last curves
 - 16 jobs / 16 tasks / 4 steps
- ▶ DeWALT battery (see page 18)

Options

- ▶ Zigbee protocol communication (IEEE 802 15,4 ; 2,4 GHz) to QBE Specialist or QBE Node Network controllers
- ▶ Barcode scanner



THE RANGE



Straight screwdriver



Pistol screwdriver



Angle head screwdriver



Angle head



Tubenut offset head



Closed gear offset head



Hold & Drive

Special outputs

OVERVIEW



Straight cordless screwdrivers - B series



Barcode scanner version



✓ Ergonomics

- Programming via the tool's USB port using ATB software (Alpha ToolBox)
- Visual and/or audible signals to inform the user of the status obtained (OK, NOK, unscrewing, etc.)
- Battery charge level indicator
- Screwdriver noise level <70 dB(A)

✓ Adaptability

- 16 jobs with 4 steps (possible sequences) can be programmed into the tool memory
- Integrated barcode scanner (optional)

✓ Quality

- Stores last 500 tightening results and last 2 curves

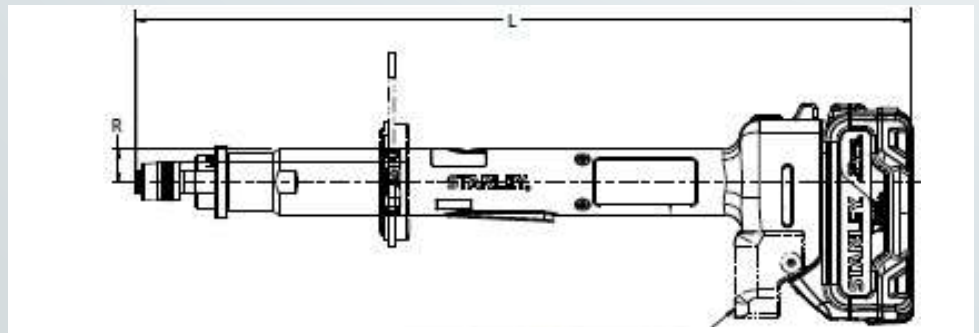

Straight cordless screwdrivers lever start

Designation	Torque maxi (Nm)	Speed (rpm)	R (mm)	L (mm)	Total weight (kg)	Weight tool alone (kg)	Drive* (standard)	Code	Code with barcode scanner
B12LB-5	5	1257	17,8	423,5	1,45	0,82	Hex 1/4"	P170341	P170361
B12LB-8	8	873	17,8	423,5	1,45	0,82	Hex 1/4"	P170342	P170362
B12LB-11	11	602	17,8	423,5	1,45	0,82	Hex 1/4"	P170343	P112499

Battery and charger not included.

* Other drives on request.

Pistol cordless screwdrivers - B series



✓ Ergonomics

- Programming via the tool's USB port using ATB software (Alpha ToolBox)
- Visual and/or audible signals to inform the user of the status obtained (OK, NOK, unscrewing, etc.)
- Battery charge level indicator
- Screwdriver noise level <70 dB(A)

✓ Adaptability

- 16 jobs with 4 steps (possible sequences) can be programmed into the tool memory
- Integrated barcode scanner (optional)

✓ Quality

- Stores last 500 tightening results and last 2 curves

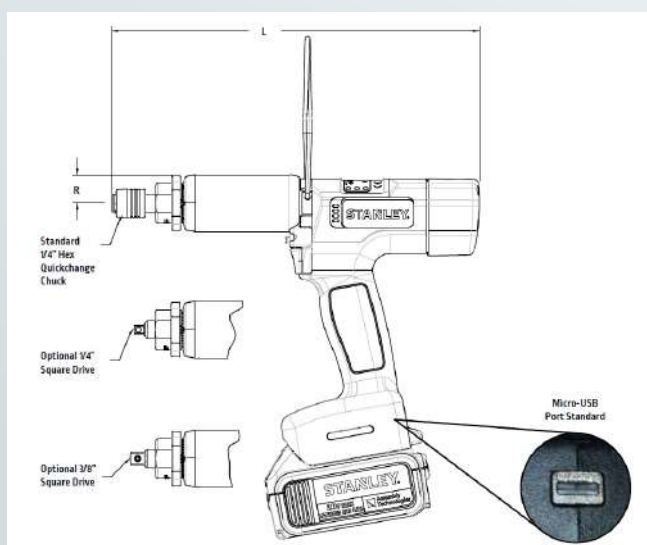

Pistol cordless screwdrivers trigger start

Designation	Torque maxi (Nm)	Speed (rpm)	R (mm)	L (mm)	Total weight (kg)	Weight tool alone (kg)	Drive* (standard)	Code	Code with barcode scanner
B12PB-5	5	1257	20	264	1,82	1,14	Hex 1/4"	P113007	P112465
B12PB-8	8	873	20	264	1,82	1,14	Hex 1/4"	P105670	P104892
B12PB-11	11	602	20	264	1,82	1,14	Hex 1/4"	P170295	P170339
B12PB-15	15	375	20	264	1,82	1,14	Hex 1/4"	P108665	P170347

Pistol cordless screwdrivers push start

Designation	Torque maxi (Nm)	Speed (rpm)	R (mm)	L (mm)	Total weight (kg)	Weight tool alone (kg)	Drive* (standard)	Code	Code with barcode scanner
B12PP-5	5	1257	20	264	1,82	1,14	Hex 1/4"	P170257	P170363
B12PP-8	8	873	20	264	1,82	1,14	Hex 1/4"	P170258	P170364
B12PP-11	11	602	20	264	1,82	1,14	Hex 1/4"	P170259	P170365

Battery and charger not included.

* Other drives on request.

Angle head cordless screwdrivers - B series



✓ Ergonomics

- Programming via the tool's USB port using ATB software (Alpha ToolBox)
- Visual and/or audible signals to inform the user of the status obtained (OK, NOK, unscrewing, etc.)
- Battery charge level indicator
- Screwdriver noise level <70 dB(A)

✓ Adaptability

- 16 jobs with 4 steps (possible sequences) can be programmed into the tool memory
- Integrated barcode scanner (optional)

✓ Quality

- Stores last 500 tightening results and last 2 curves

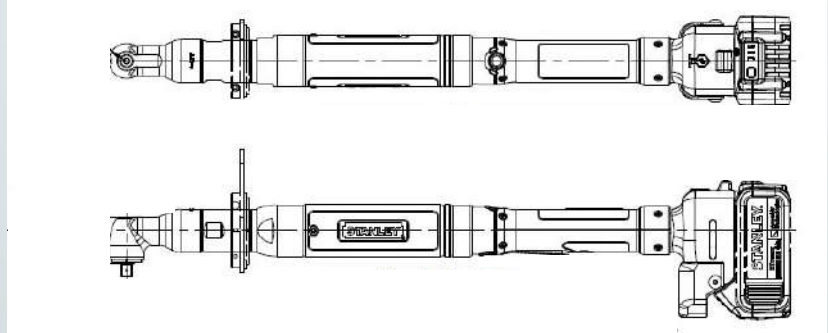

Angle head cordless screwdrivers lever start

Designation	Torque maxi (Nm)	Speed (rpm)	R (mm)	L (mm)	H (mm)	Total weight (kg)	Weight tool alone (kg)	Drive* (standard)	Code	Code with barcode reader
B12LA13-8	8	838	13	386,1	33,2	1,65	1,04	Carré 3/8"	P108669	P108739
B12LA13-11	11	582	13	386,1	33,2	1,65	1,04	Carré 3/8"	P113122	P170360
B12LA13-16	16	401	13	386,1	33,2	1,65	1,04	Carré 3/8"	P106784	P108801
B23LA13-12	12	665	13	537	33,2	2,41	1,74	Carré 3/8"	P112510	P170318
B23LA13-15	15	600	13	537	33,2	2,41	1,74	Carré 3/8"	P170294	P170348
B23LA13-17	17	460	13	537	33,2	2,41	1,74	Carré 3/8"	P105681	P170319
B23LA15-23	23	370	15	552	39,9	2,58	1,95	Carré 3/8"	P108807	P112768
B23LA15-35	35	230	15	567	39,9	2,65	1,98	Carré 3/8"	P113114	P116841
B23LA18-42	42	180	18	563	39,9	2,83	2,11	Carré 3/8"	P170323	P170320
B23LA19-52	52	155	19	592	47,8	2,99	2,32	Carré 1/2"	P103468	P112473
B23LA19-70	70	140	19	653	47,8	3,61	2,95	Carré 1/2"	P104874	P170321
B23LA22-95	95	105	22	660	47,9	3,61	3,45	Carré 1/2"	P108671	P106761
B33LA13-14	14	1698	13	561,7	33,2	2,77	1,72	Carré 3/8"	P116842	P170349
B33LA13-18	18	1372	13	561,7	33,2	2,77	1,72	Carré 3/8"	P170328	P170350
B33LA15-25	25	959	15	576,8	39,9	2,99	1,95	Carré 3/8"	P112784	P170351
B33LA15-40	40	525	15	592,0	39,9	3,04	2,00	Carré 3/8"	P170329	P170352
B33LA18-48	48	455	18	587,5	39,9	3,13	2,09	Carré 3/8"	P112608	P170353
B33LA19-55	55	439	19	617,0	47,8	3,36	2,31	Carré 1/2"	P170331	P170354
B33LA19-70	70	356	19	677,5	47,8	3,99	2,95	Carré 1/2"	P170332	P170355
B33LA22A-95	95	237	22	685,2	47,9	4,17	3,13	Carré 1/2"	P170333	P170356
B44LA19-55	55	573	19	715,3	47,8	5,20	3,94	Carré 1/2"	P170334	P170357
B44LA19-70	70	425	19	715,3	47,8	5,20	3,94	Carré 1/2"	P170335	P170358
B44LA22A-95	95	328	22	723,0	47,9	5,40	4,11	Carré 1/2"	P170336	P170359
B44LA22A-120	120	243	22	723,0	47,9	5,40	4,11	Carré 1/2"	P112439	P108681

Battery and charger not included.

* Other drives on request.

Batteries for screwdrivers - B series

✓ Autonomy

- Up to 2 200 cycles** per full charge for the 18 V - 5 Ah battery
- Up to 3 300 cycles** per full charge for the 54 V – 162 Wh battery

✓ Ergonomics

- Battery charge level indicator with 3 LEDs



18 V battery



54 V battery



Single battery charger



Dual battery charger

Designation	Type	Weight (kg)	Code
N565456	18 V - 2 Ah battery	0,40	P100677
E008500	18 V - 5 Ah battery	0,63	P101268
N530919	54V/18 V - 108 Wh battery	1	P104882
N630923	54V/18 V - 162 Wh battery	1,3	P103819
N630880	18 V/54 V 1 battery charger	-	P101015
N630892	18 V/54 V 2 battery charger	-	P170183

- 18 V batteries are dedicated to low-torque screwdrivers only (B12- B23).
- 54 V /18 V batteries are adaptable on the entire range (automatic recognition of tool voltage).

** Data varies according to application.

ALPHA V QBE CONTROLLERS



Alpha V QBE controllers are torque and angle control boxes compatible with all « torque and angle » screwdrivers in the STANLEY® range.

They meet advanced requirements in terms of tightening strategies, traceability and communication.

- ▶ A single control platform for the full range of STANLEY® tools up to 2 000 Nm.
- ▶ IP 54 protection rating.
- ▶ Configuration from front panel or Alpha Toolbox software via any web browser.
- ▶ 24 V Input / Output, USB, Ethernet, serial and fieldbus options.

Technical specifications

Dimensions (L x H x P)	15 cm x 36 cm x 26 cm
Weight	7,6 kg
I/O power supply	24 V DC, 1 A internal, ready for external power supply
AC power source	Automatic detection 100 to 126,5 V or 200 to 253 V AC, 50 or 60 Hz
Humidity	0 to 95 % non-condensing
Temperature	0 to 50 °C

Equipment supplied







Each controller is supplied with:

- 230 V power cord, 2 m long (ref. 20C102102)
- A wall-mounting plinth (ref. 20E204300)
- A 16-pin connector for 24 V DC digital I/O (ref. 20C104806 – code **P108776**)

Tightening strategies and memory available

	For corded tools	For cordless tools
Number of jobs / Tasks / Steps	255 jobs / 99 tasks / 12 steps	16 jobs / 16 tasks / 4 steps
Strategies available	<ul style="list-style-type: none"> Torque control + angle monitoring (CC/SA) Angle control + torque monitoring (CA/SC) Angle control + torque control (CA/CC) Drag torque (CA/MC) Slope control (CP/SA) Tightening at the yield point (LIM/SA) Untightening (clear) Back to position (CP/SC) 	<ul style="list-style-type: none"> Torque control + angle monitoring (CC/SA) Angle control + torque monitoring (CA/SC) Untightening (clear)
Memory	30 000 latest results and associated curves	500 latest results and 2 latest associated curves

Communications et connections

	RS 232 serial port	Ethernet ports	USB	Inputs / outputs 24 V DC	Modbus / TCP	Ethernet port RJ45 to Alpha Toolbox	Integrated PLC
	 <ul style="list-style-type: none"> Factory network connection for data retrieval on the fly / open protocol <p>OR</p>  <ul style="list-style-type: none"> Job selection by barcode scanner and/or label printing 	 <ul style="list-style-type: none"> To connect the box to the factory network <p>OR</p> <ul style="list-style-type: none"> To connect 2 boxes (e.g. : Advanced + Node) for application with 2 tools 	 <ul style="list-style-type: none"> Retrieval data stored on USB key Backup, restore settings controllers and update software Barcode ASCII if not use by internal PLC 	 <ul style="list-style-type: none"> Assignables Parameterisable (NO/NF) Selection of jobs per socket tray or PLC external Exchanges with IHM 	<ul style="list-style-type: none"> Connection factory network 	 <p>Dedicated to programming only by PC using the internet browser</p> <ul style="list-style-type: none"> Update software Backup, restore settings controller Analysis curves and results 	
Advanced model	✓	✓	✓	8 inputs / 8 outputs	✓	✓	✓
Expert model	✓	✓	✓	8 inputs / 8 outputs	✓	✓	✓
Node model	X	✓	X	X	X	✓	X
Specialist model	✓	✓	✓	8 inputs / 8 outputs	✓	✓	✓
Node Network model	✓	✓	X	8 inputs / 8 outputs	✓	✓	X

Alpha V QBE Advanced controller

Alpha V Advanced controller is torque and angle control box single-channel compatible with all EA, EB et EC corded screwdrivers. It can also control a dual spindle system by adding a Node controller or a second Advanced controller in « Master – Slave » mode.

Compatible with corded tools



✓ **Ergonomics**

- Color display with keyboard
- Quick parameter setting from the keyboard or PC via the Ethernet port using the software Alpha ToolBox

✓ **Adaptability**

- Integrated PLC
- Modbus TCP and OpenProtocol
- Linking tightening sequences
- ATC, ATC+ and Soft Stop modes
- Screw counting

✓ **Quality**

- Error detection
- Maintenance support
 - Diagnostics
 - Cycle counter



Dual spindle system

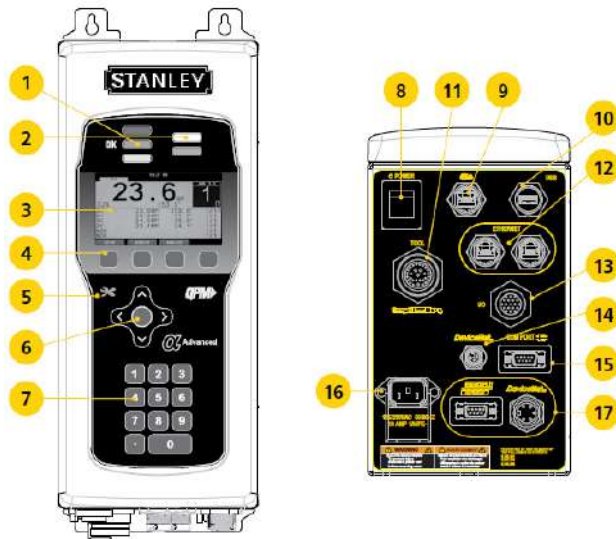

1	Red, green and yellow LEDs to visualise tightening results
2	LED tool ready
3	LCD display
4	Function keys with associated menu above
5	Maintenance indicator
6	Numeric keyboard for setting parameters or selecting options
7	Arrows to move the cursor and center button to view lists
8	POWER ON/OFF button
9	Ethernet port dedicated to Alpha ToolBox embedded configuration and analysis software
10	USB port for data transfer
11	Tool connector
12	2 Ethernet ports for network connection (Modbus/TCP, OpenProtocol) and/or serial connection of several controllers
13	24 V DC I/O connector (8 inputs / 8 outputs configurable and assignable to on/off logic)
14	DeviceNet master port (option, MXV only)
15	RS232 serial port for OpenProtocol data retrieval or connection of a barcode scanner (ASCII) or industrial printer
16	Power supply
17	Optional: DeviceNet (XDV), Profibus (XPV), ProfiNet (XNV), Ethernet IP (XEV) slave network ports

Designation	24V I/O	DeviceNet	Profibus	Ethernet / IP	Profinet	GMPorts	Code
Alpha V Controller - QB3101-XXV - Advanced	✓						P100166
Alpha V Controller - QB3101-XDV - Advanced	✓	✓					P103477
Alpha V Controller - QB3101-XPV - Advanced	✓		✓				P105620
Alpha V Controller - QB3101-XEV - Advanced	✓			✓			P101222
Alpha V Controller - QB3101-XNV - Advanced	✓				✓		P100516
Alpha V Controller - QB3101-XGV - Advanced	✓					✓	P170261

Alpha V QBE Expert controller

Alpha V Expert controller is "THE" ultimate multi-channel controller. It can manage up to 24 tools, 23 of which are « slaves » via a network of Advanced or Node controllers connected in series via their Ethernet ports. Among these 24 tools, the Alpha V Expert can control a maximum of 15 cordless tools.



Compatible with corded and cordless tools

✓ **Ergonomics**

- Color display with keyboard
- Quick parameter setting from the keyboard or PC via the Ethernet port using the Alpha ToolBox software

✓ **Adaptability**

- Integrated PLC
- Modbus TCP and OpenProtocol
- Linking tightening sequences
- ATC, ATC+ and Soft Stop modes
- Screw counting

✓ **Quality**

- Error detection
- Maintenance support
 - Diagnostics
 - Cycle counter

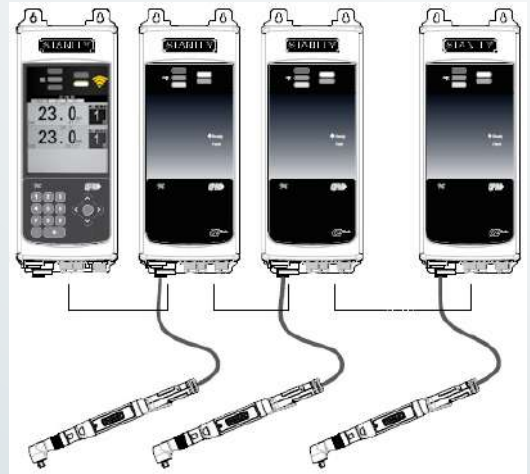

Multi-channel system



1	Red, green and yellow LEDs to visualise tightening results
2	LED tool ready
3	LCD display
4	Function keys with associated menu above
5	Maintenance indicator
6	Numeric keyboard for setting parameters or selecting options
7	Arrows to move the cursor and center button to view lists
8	POWER ON/OFF button
9	Ethernet port dedicated to Alpha ToolBox embedded configuration and analysis software
10	USB port for data transfer
11	Tool connector
12	Ethernet port for network connection (Modbus/TCP, OpenProtocol)
13	Ethernet port for serial connection of several controllers
14	24 V DC I/O connector (8 inputs / 8 outputs configurable and assignable to on/off logic)
15	DeviceNet master port (option, MXV only)
16	RS232 serial port for OpenProtocol data retrieval or connection of a barcode scanner (ASCII) or industrial printer
17	Power supply
18	Optional: DeviceNet (XDV), Profibus (XPV), ProfiNet (XNV), Ethernet IP (XEV) slave network ports

Designation	24V I/O	DeviceNet	Profibus	Ethernet / IP	Profinet	GMPorts	Code
Alpha V Controller - QB4101-XXV - Expert	✓						P101701
Alpha V Controller - QB4101-XDV - Expert	✓	✓					P116840
Alpha V Controller - QB4101-XPV - Expert	✓		✓				P170340
Alpha V Controller - QB4101-XEV - Expert	✓			✓			P170345
Alpha V Controller - QB4101-XNV - Expert	✓				✓		P104888
Alpha V Controller - QB4101-XGV - Expert	✓					✓	P170346

Alpha V QBE Node controller

Alpha V Node controller is torque and angle control box single-channel compatible with all E, EA, EB, EC corded screwdrivers. It is used to manage a tool in slave mode, controlled by an Expert, Advanced, or Specialist box.

Compatible with corded tools



✓ Ergonomics

- Simplified user interface with LED
- Quick parameter setting on PC via the Ethernet port using the Alpha ToolBox software or from the master controller

✓ Adaptability

- OpenProtocol
- Linking tightening sequences
- ATC, ATC+ and Soft Stop modes
- Screw counting

✓ Quality

- Error detection
- Maintenance support
 - Diagnostics
 - Cycle counter

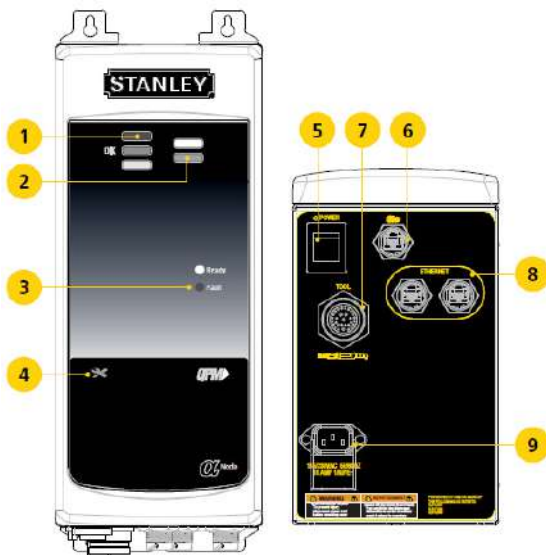

1	Red, green and yellow LEDs to visualise tightening results
2	LED tool ready
3	LED Ready / Fault
4	Maintenance indicator
5	POWER ON/OFF button
6	Ethernet port dedicated to Alpha ToolBox embedded configuration and analysis software
7	Tool connector
8	Ethernet port for serial connection of several controllers
9	Power supply

Designation

Alpha V Controller - QB0101-XXV - Node

Code

P105667

Alpha V QBE Specialist controller

Alpha V Specialist controller is torque and angle control box multi-channel compatible with B series standalone screwdrivers. It allows to manage up to 15 cordless tools. By adding Advanced or Node controllers, it can drive up to 24 tools, including a maximum of 15 battery tools.

Compatible with cordless tools



✓ **Ergonomics**

- Large colour touch display with keyboard
- Quick parameter setting from the keyboard or PC via the Ethernet port using the Alpha ToolBox software

✓ **Adaptability**

- Integrated PLC
- Modbus TCP and OpenProtocol
- Linking tightening sequences
- ATC, ATC+ and Soft Stop modes
- Screw counting

✓ **Quality**

- Error detection
- Maintenance support
 - Diagnostics
 - Cycle counter

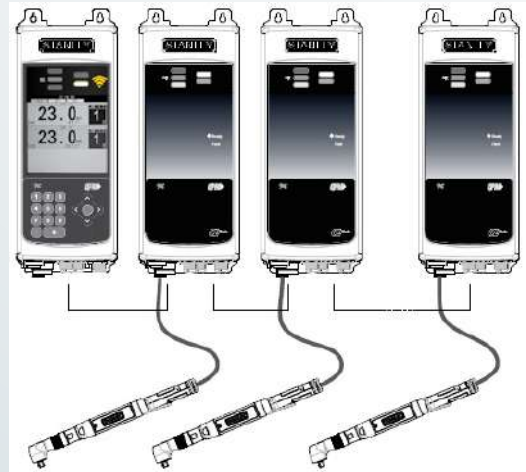

Multi-channel system



1	Red, green and yellow LEDs to visualise tightening results
2	LED tool ready
3	LCD colour touch display
4	Function keys with associated menu above
5	Maintenance indicator
6	Numeric keyboard for setting parameters or selecting options
7	Arrows to move the cursor and center button to view lists
8	POWER ON/OFF button
9	Ethernet port dedicated to Alpha ToolBox embedded configuration and analysis software
10	USB port for data transfer
11	Ethernet port for network connection (Modbus/TCP, OpenProtocol)
12	Ethernet port for serial connection of several controllers
13	24 V DC I/O connector (8 inputs / 8 outputs configurable and assignable to on/off logic)
14	RS232 serial port for OpenProtocol data retrieval or connection of a barcode scanner (ASCII) or industrial printer
15	Power supply
16	Optional: DeviceNet (XDV), Profibus (XPV), ProfiNet (XNV), Ethernet IP (XEV) slave network ports

Designation	24V I/O	DeviceNet	Profibus	Ethernet / IP	Profinet	GMPorts	Code
Alpha V Controller - QB5100-XXV - Specialist	✓						P104295
Alpha V Controller - QB5100-XDV - Specialist	✓	✓					P170366
Alpha V Controller - QB5100-XPV - Specialist	✓		✓				P170367
Alpha V Controller - QB5100-XEV - Specialist	✓			✓			P104898
Alpha V Controller - QB5100-XNV - Specialist	✓				✓		P112513
Alpha V Controller - QB5100-XGV - Specialist	✓					✓	P170368

Alpha V QBE Node Network controller

The Alpha V Node Network controller is torque and angle control box compatible with all B series standalone screwdrivers. It is used to manage 1 to 6 B series tools.

Compatible with cordless tools



✓ Ergonomics

- Simplified user interface with LED
- Quick parameter setting on PC via the Ethernet port using the Alpha ToolBox software or from the master controller

✓ Adaptability

- Modbus and OpenProtocol
- Linking tightening sequences
- ATC, ATC+ and Soft Stop modes
- Screw counting

✓ Quality

- Error detection
- Maintenance support
 - Diagnostics
 - Cycle counter

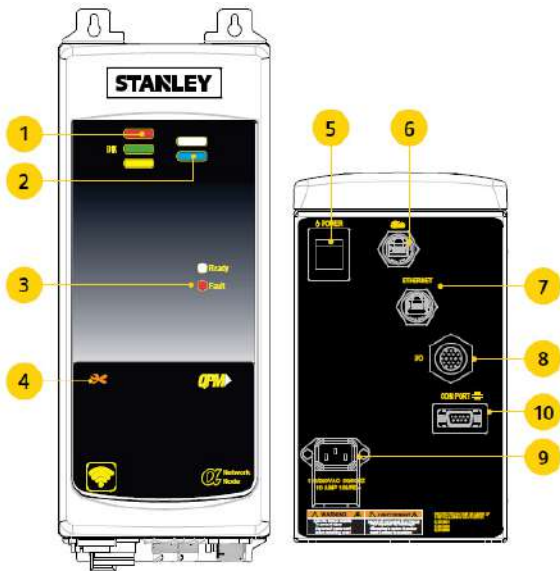

1	Red, green and yellow LEDs to visualise tightening results
2	LED tool ready
3	LED Ready / Fault
4	Maintenance indicator
5	POWER ON/OFF button
6	Ethernet port dedicated to Alpha ToolBox embedded configuration and analysis software
7	Ethernet port for serial connection of several controllers
8	24 V DC I/O connector (8 inputs / 8 outputs configurable and assignable to on/off logic)
9	Power supply
10	RS232 serial port for OpenProtocol data retrieval or connection of a barcode scanner (ASCII) or industrial printer

Designation	Code
Node Network Controller Wi-Fi 802.11 b/g/n - QB0201	P170322
Node Network Controller Wi-Fi 802.15.04 ZIGBEE - QB0101	P170370

All Alpha V controllers from the QBE range are fitted with Alpha ToolBox embedded software and an Ethernet port dedicated exclusively to local use.



Visualisation of the last tightening and storage of results for analysis



Display and analysis of one or more superimposed curves

Programmed settings can be downloaded and saved

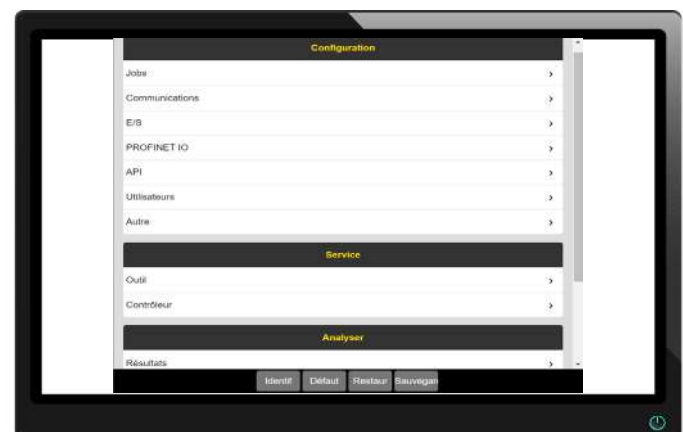
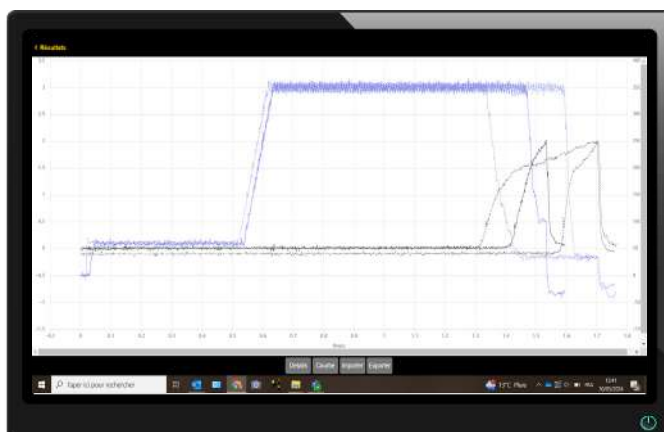

ATC adaptive tightening control function

Available on all controllers in the QBE Alpha V range, the adaptive tightening control is a speed change function patented by STANLEY®.

For each tightening cycle using the same programme, the controller brake according 3 predefined parameters.

The start and end of braking limits are defined according to the type of assembly (elastic --> rigid).

The tool brakes in inverse proportion to the increase in torque, to finish at the programmed final speed, which is generally slow for a precise stop at the setpoint.

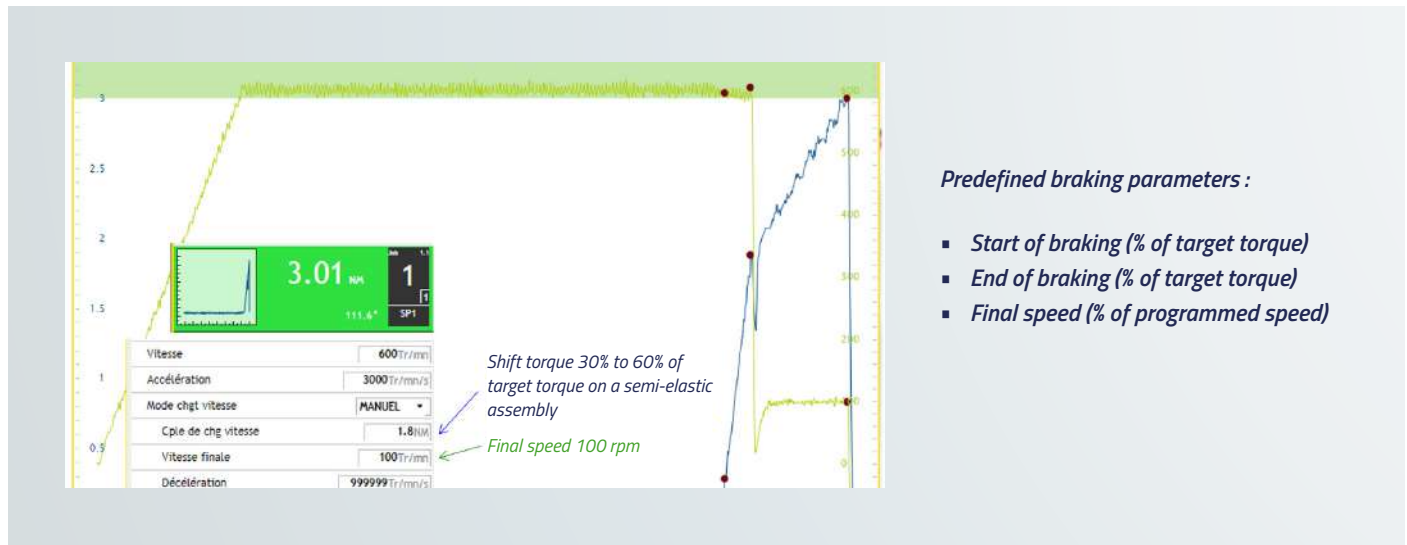

ATC+ auto-adaptive tightening control function

Available on all controllers in the QBE Alpha V range, auto-adaptive tightening control is a speed change function patented by STANLEY®.

For each tightening cycle using the same programme, the controller adapts the tool braking dynamically and automatically as a function of the increase in torque.

The slope of the torque rise is calculated between the 2 defined limits:

- Low limit (% of target torque)
- High limit (% of target torque)

The final speed will be defined as a % of the nominal speed of the tool.

Thanks to ATC+, The tool self-adapts its final braking depending on the type of assembly (elastic – rigid) to optimise cycle times.

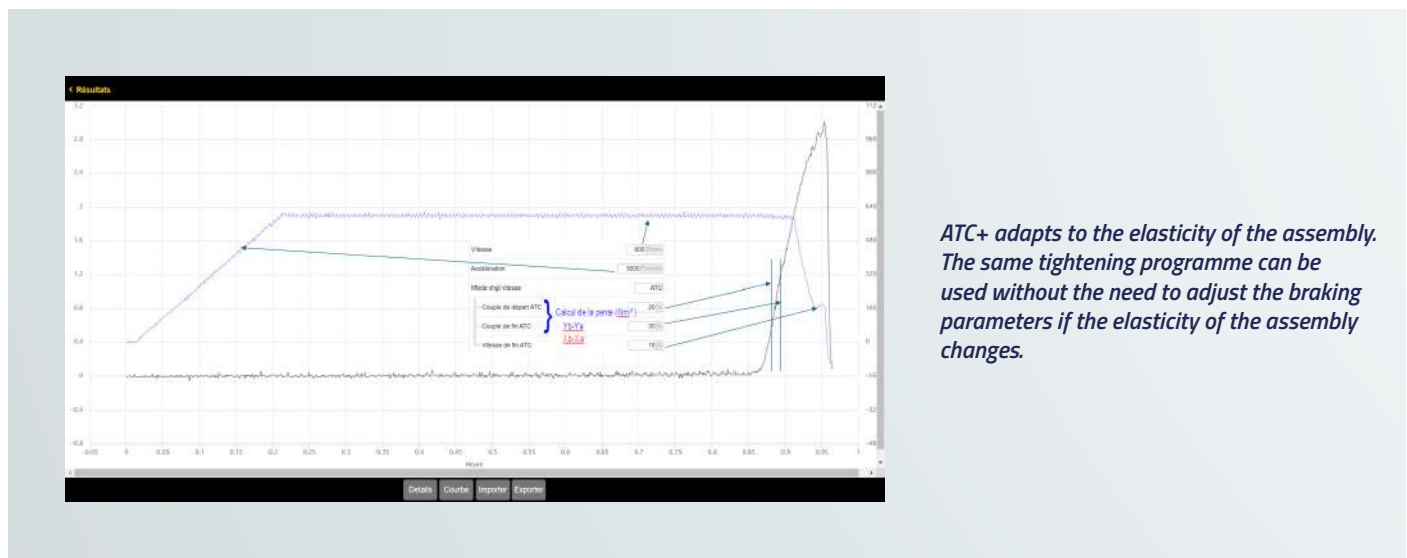

ACCESSORIES

Cables and extensions for EB series electric screwdrivers

- ▶ Robotics-approved cables.
- ▶ 10-meters cable available on request.
- ▶ All cables have a minimum bending radius of 8 cm.
- ▶ Max. 2 cabling elements (1 cable + 1 extension).

Step 1

Select the right cable for your tool model

Step 2

Select the appropriate extension cable

*For portable tools
EB12 to EB33
Lite cables*

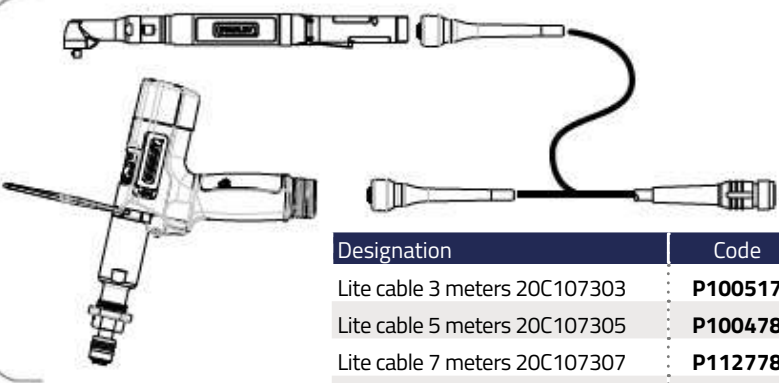

Designation	Code
Lite cable 3 meters 20C107303	P100517
Lite cable 5 meters 20C107305	P100478
Lite cable 7 meters 20C107307	P112778
Lite cable 10 meters 20C107310	P104919

*For portable tools
EB12 to EB55
Reinforced cables*

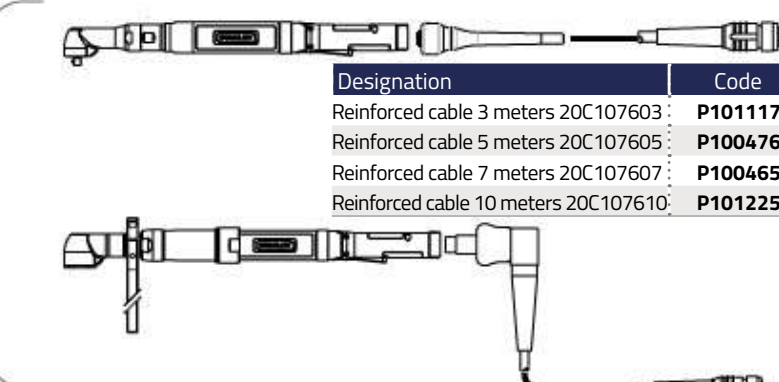

Designation	Code
Reinforced cable 3 meters 20C107603	P101117
Reinforced cable 5 meters 20C107605	P100476
Reinforced cable 7 meters 20C107607	P100465
Reinforced cable 10 meters 20C107610	P101225

Designation	Code
Reinforced cable 90° 3 meters 20C107703	P106860
Reinforced cable 90° 5 meters 20C107705	P170194

*For fixed tools
EB33 to EB55
and for portable tools pistol with
Top Exit option*

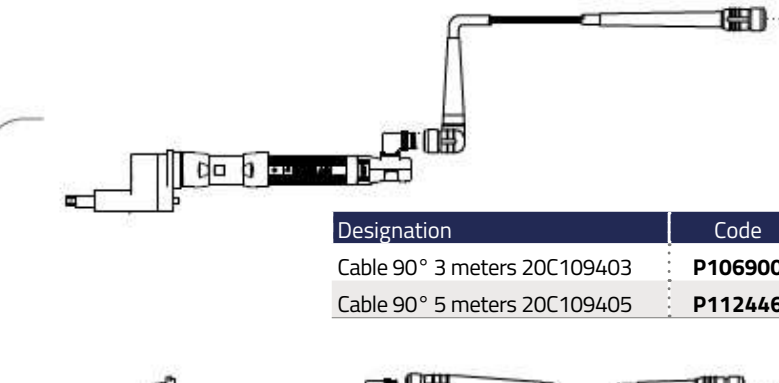

Designation	Code
Cable 90° 3 meters 20C109403	P106900
Cable 90° 5 meters 20C109405	P112446

Designation	Code
Cable 3 meters 20C109303	P101998
Cable 5 meters 20C109305	P101226
Cable 7 meters 20C109307	P102656
Cable 10 meters 20C109310	P106934



Designation	Code
Extension 5 meters 20C107505	P101121
Extension 10 meters 20C107510	P100535
Extension 20 meters 20C107520	P101122
Extension 40 meters 20C107540	P112860

Reaction bar

Designation	Code
Straight: EB12, B12 Pistol: EB12, EB22, EB33, EB34, B12	P106918
Straight: EB22, EB33	P112611
Straight: EB34, EB44, EB45, EB55 Angle head: EB22LA15, EB33LA15, EB33LA19, EB34, EB44, B44	P112615
Angle head: EB45, EB55, B33	P112617
Angle head: EB55LA32-400	P170291



Mounting bracket

Designation	Code
Straight: EB22, EB33, EB34, EB44, EB45, EB55 Angle head: EB12, EB22, EB33, B44	P170281
Angle head: EB34, EB44, EB45, EB55, B33	P170282



Mounting flange

Designation	Code
Straight: EB22, EB33	P112619
Angle head: EB12, EB22, EB33, B33, B44	P170276
Straight: EB34, EB44	P170292
Angle head: EB34, EB44, EB45, EB55	P170277
Straight: EB45, EB55	P170277



Rotating suspension ring

Designation	Code
EB22, EB33	P101695
EB34, EB44	P102005
EB45, EB55	P104321

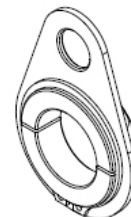

Protective sheath for angle head tools

Designation	Code
EB12LA10, EB12LA13, EB22LA13	P170285
EB22LA15, EB33LA15	P101274
EB33LA18	P170287
EB33LA19, EB34LA19, EB44LA19	P106753
EB34LA22, EB44LA22	P170288
EB45LA26, EB55LA26	P170289
EB55LA32	P170290



Long lever

Designation	Code
Straight: EB33, EB34, EB44, EB45, EB55 Angle head: EB33, EB34, EB44, EB45, EB55	P108819



Dual hands start system

Designation	Code
Straight and angle head: EB33L	P170428
Straight and angle head: EB34L	P170430
Straight and angle head: EB44L	P170431
Straight and angle head: EB45L	P170432
Straight and angle head: EB55L	P170429
Straight and angle head: B23L, B33L	P170433



Lighting kit

Designation	Code
Straight and angle head: EB33L, B23L, B33L	P112840
Straight and angle head: EB34L	P170434



Mounting interface / Reaction arm

Designation	Code
Mounting interface for EB12	P101703
Mounting interface for EB22, EB23	P103466
Mounting interface for EB33	P101456



Programming cable for B series cordless screwdrivers

Designation	Code
Programming cable 20C206600	P104880

Anti-vibration guided extension kit for angle head

Designation	Code
Guided extension kit Lenght 100 to 200 mm depending on the angle head model	On request



OUR SERVICES

At DOGA we put at your disposal our reliable, accurate and user-friendly tightening solutions. It is our duty to advise you of the right solution for your application. Our Product Manager and Support engineering teams are here to analyze your manufacturing process and share with you our innovative solutions to improve your assembly process. Thanks to our technical integration service CELPRO, we provide you with turnkey solutions from design to commissioning.



TURNKEY SOLUTIONS

Using all the options of our complete product range, we offer you solutions adapted to your needs.

- ▶ Custom Design
- ▶ Adaptation of existing models
- ▶ Integration of automation system



TECHNICAL ASSISTANCE

To ensure the optimal performance and durability of our tools, we put our technical assistance at your disposal.

- ▶ Installation and start-up
- ▶ Maintenance agreement
- ▶ On-site maintenance
- ▶ Maintenance in our workshop



TRAINING

DOGA offers specialized training courses for our industries:

- ▶ Technical & practical
- ▶ Audit & Consulting

EXAMPLES OF INTEGRATION

Our project cell CELPRO designs and produces integrated tightening solutions that meet your productivity, ergonomics and quality needs:

- ▶ Complete workstation
- ▶ Multi-spindle tightening
- ▶ Process control and traceability
- ▶ Tightening modules
- ▶ Special torque reaction arms
- ▶ Special tools and accessories



Scan the QR code to view our integration examples



*Synchronised double-spindle
(center distance 55 mm)
DOC.40991*



*Double-spindle for wheel tightening
(torque 105 Nm,
center distance 100 mm)
DOC.40453*



*6 spindles screw head
(variable center distances,
tightening torque 100 Nm)
DOC.40620*



*Mobile workstation for
tightening under truck body
(torque 75 Nm)
DOC.40662*

RELATED PRODUCTS



Assembly tools

The wide range of DOGA industrial screwdrivers will meet your production and quality requirements:

- Torque and angle control electric tools
- Torque and angle transducerized control tools STANLEY®
- Brushless electric tools

> [Learn more about our assembly tools](#)



Torque reaction arms and tool positioning system

The widest and most complete range on the market:

- BA series - Linear, articulated, travelling torque reaction arms
- DMF series - Carbon fiber telescopic torque reaction arms
- SLIDER series - Suspended torque reaction arms
- Special torque reaction arms

> [Learn more about our torque reaction arms](#)



Screw feeding

Reduce your cycle times thanks to our automatic screw feeding system:

- DMA - Auto-advanced automatic screw feeding system
- DMS - Telescopic automatic screw feeding system
- DMM - Automatic screw feeding system magnetic
- Semi-automatic screw feeding with interchangeable or fixed rails

> [Learn more about screw feeding](#)



Find all our ASSEMBLY TECHNOLOGY products on our website by scanning this QR code

